

## Quick Installation Guide

AC1200 Dual Band WiFi Repeater  
A18



Get Support and Services

Scan the QR code or visit [www.tenda.cn](http://www.tenda.cn) for installation videos, technical specifications, user guides and more information.

You can see the product name and model on the product label. The label can be found on the back of the device.

### 1. Power on the repeater

Plug the repeater into a power outlet near the WiFi router. Ensure that the **PWR** LED indicator is solid on.

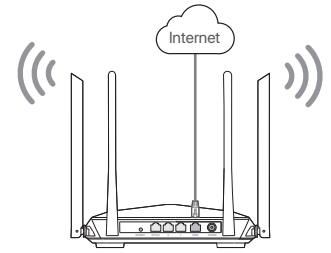
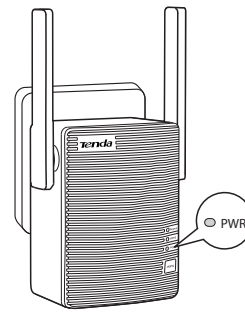

### 2. Connect the repeater to the internet

#### Method 1: Set up the repeater by web UI

①. Connect the client to the repeater.

Method 1: Connect the WiFi-enabled device such as a smartphone to the Wi-Fi network of repeater.

Method 2: Use an Ethernet cable to connect the computer to the LAN port of the repeater.

**Tips**  
The default Wi-Fi name (SSID) is Tenda\_EXT. By default, it has no password.

②. You will be directed to the quick setup page within one minute.

If not, start a web browser, and enter **re.tenda.cn** or **192.168.0.254** in the address bar to access the repeater's web UI. (Example: smartphone)

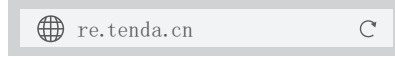

③. Create a login password for security (recommend) and click **Next**.

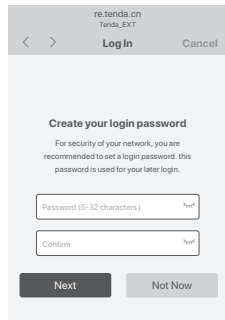

④. Select the WiFi network (SSID) you want to extend.

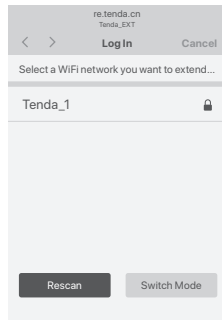

⑤. If the WiFi network you chose is encrypted, enter the password for the selected WiFi network. Modify your repeater's SSID (optional), and click **Extend**.

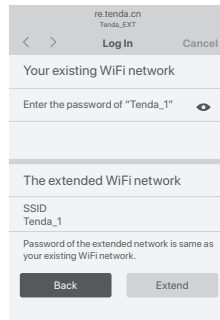

Wait until the **Extended successfully** page appears.

#### Method 2: Set up the repeater by WPS button

**Tips**  
This method is applicable for the WiFi router having a WPS button, which may be indicated by , , or .

①. Press the **WPS** button on the WiFi router to enable its WPS function.

②. Within 2 minutes, press the **WPS** button (1-3s) on the repeater.

The **WPS** LED indicator blinks. When the **WPS** LED indicator lights solid on, and the **Signal** LED indicator lights solid on, the setup is successful.

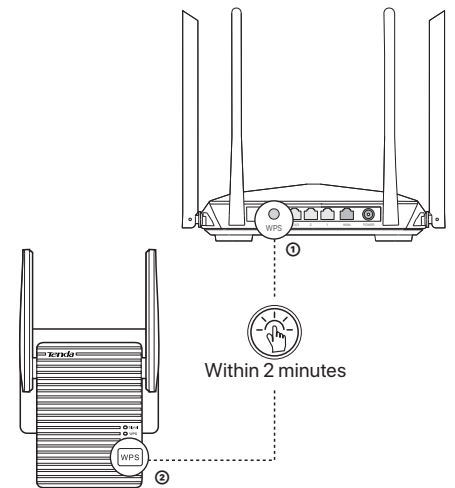

### 3. Relocate the repeater

①. Refer to the following relocation tips to locate the repeater to obtain a better performance.

- Place the repeater between the WiFi router and the WiFi dead zone (within the coverage of the router).
- Keep your repeater away from electronics with strong interference, such as microwave ovens, induction cookers, and refrigerators.
- Place the repeater in a high position with few obstacles.
- Unfold the antennas and point them vertically upwards.

②. Observe the **Signal** LED indicator of the repeater to ensure the repeater is located in the proper position.

- Solid blue: Extended with good connection quality
- Solid red: Extended with poor connection quality

③. If the connection quality is poor, move the repeater closer to the WiFi router.

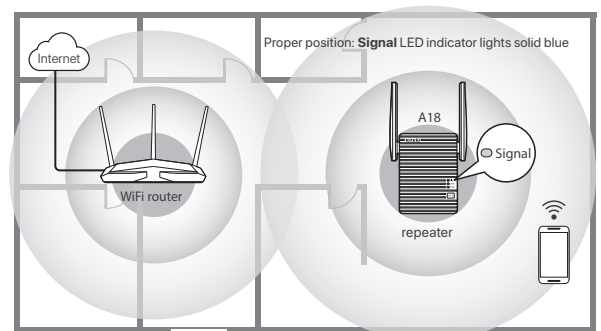

### 4. Connect clients to the internet

**WiFi-enabled device:** Connect to the WiFi network of repeater.

After extending, the WiFi name and WiFi password of the repeater are shown in the table below.

	If the repeater is set via the Web UI	If the repeater is set via the WPS button
<b>WiFi name</b>	WiFi name you set Or Your WiFi router's SSID with the suffix <b>_EXT</b> or <b>_5GEXT</b>	Your WiFi router's SSID with the suffix <b>_EXT</b> or <b>_5GEXT</b>
<b>WiFi password</b>	Same as the router	Same as the router

**Wired device:** Connect to the LAN port of repeater using an Ethernet cable.

